

WILBERG SUBDIVISION

OF

CASTLE-DALE TOWNSITE

EMERY COUNTY, UTAH

Scale 1 in = 200 ft

Ira R. Browning
Surveyor

DEDICATION

Know All Men By These Presents That we Carl Wilberg and Matilda Wilberg husband and wife of Castle-Dale, Utah, hereby certify and declare that we are the sole owners of the streets embraced in this plat; that the scale to which this plat is drawn is 200 ft. to 1 inch; that all lots shown thereon are 13 rods square; that all streets shown hereon are 6 rods wide except First, Maple, and Birch Streets which are 3 rods wide, that the following named streets and parts of streets as shown hereon viz, - First Street; Second Street from Maple Street to Oak Street and from Walnut Street to Birch Street; Third Street; Maple Street; Spruce Street from First Street to Third Street; Pine Street from Second Street to the S. E. Corner of Lot 2 Block 6 and N.E. Corner of Lot 3 Block 7; Oak Street from the East side of Second Street to Third Street allowing an opening 33 feet in width connecting Oak Street as shown; Walnut Street from First Street to Third Street and Birch Street; that this plat is hereby denominated Wilberg Subdivision of Castle-Dale Townsite Survey and the said streets are hereby dedicated to the use of the public.

In Witness Whereof we have hereunto set our hands at Castle-Dale, Utah, this 21st day of February 1914.

Carl Wilberg
Matilda Wilberg

Signed in the presence of
A. D. Dickson
Thomas R. Faddis

State of Utah
County of Emery^{ss.}

Personally appeared before me Carl Wilberg and Matilda Wilberg husband and wife the signers of the above instrument who duly acknowledged to me that they executed the same.

My Commission expires
Jan. 10, 1917.

Seal

A. D. Dickson
notary public

Accepted and approved by order of the Castle Dale Town Council regularly assembled on April 11, 1914.

Seal

C. E. Larson
President
Attest S. P. Snow
Clerk

SURVEYOR'S CERTIFICATE

I, Ira R. Browning a surveyor of Emery County do hereby certify that the within plat of Wilberg Subdivision embracing the W. 1/2 of the N. W. 1/4 of Section 34. Tp, 18, S. R, 8, E. S. L. B. & M. is correctly and accurately drawn to the designated scale from the field notes of a survey made by me between the 20th day of October and the 10th day of November, 1903. at the instance of Carl Wilberg and is designated as Wilberg Subdivision of Castle Dale Townsite.

Ira R. Browning
Surveyor

N. W. Cor
Sec 34

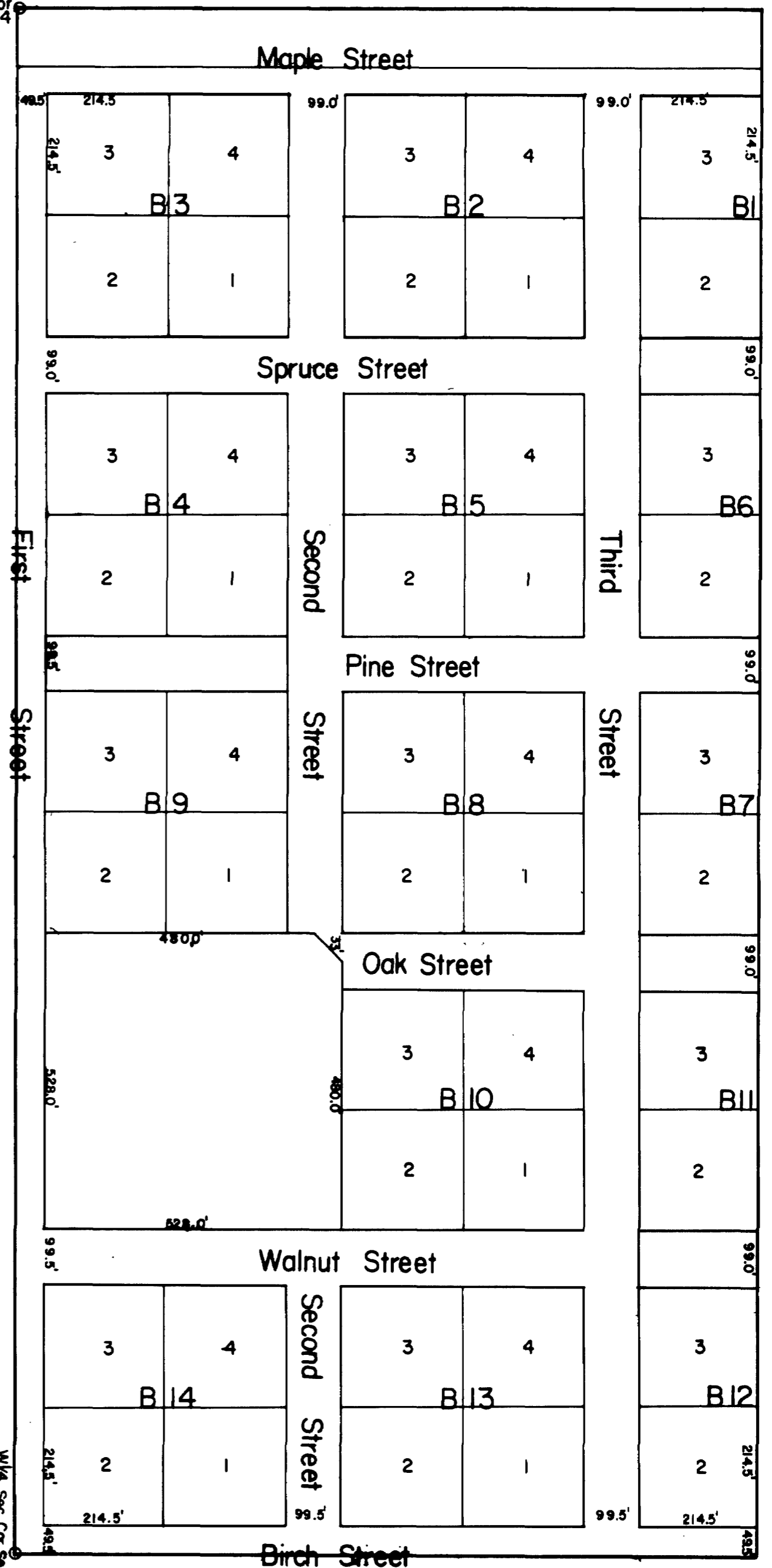

Entry No. 29828 1/2
Recorded at request of
S. P. Snow Jr.
Sept. 2, 1914 at 4 P. M.
in Book Town of Plats
Page 83
Hector T. Evans
County Recorder, Emery County, Utah.

Traced by svk
Johansen & Tuttle
7-75