

CARROLL'S SUBDIVISION ORANGEVILLE TOWNSITE EMERY CO., UTAH

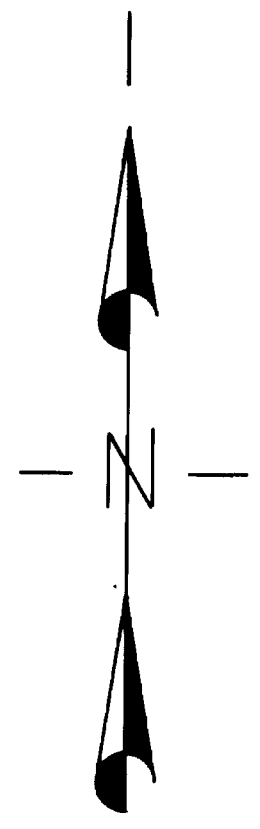
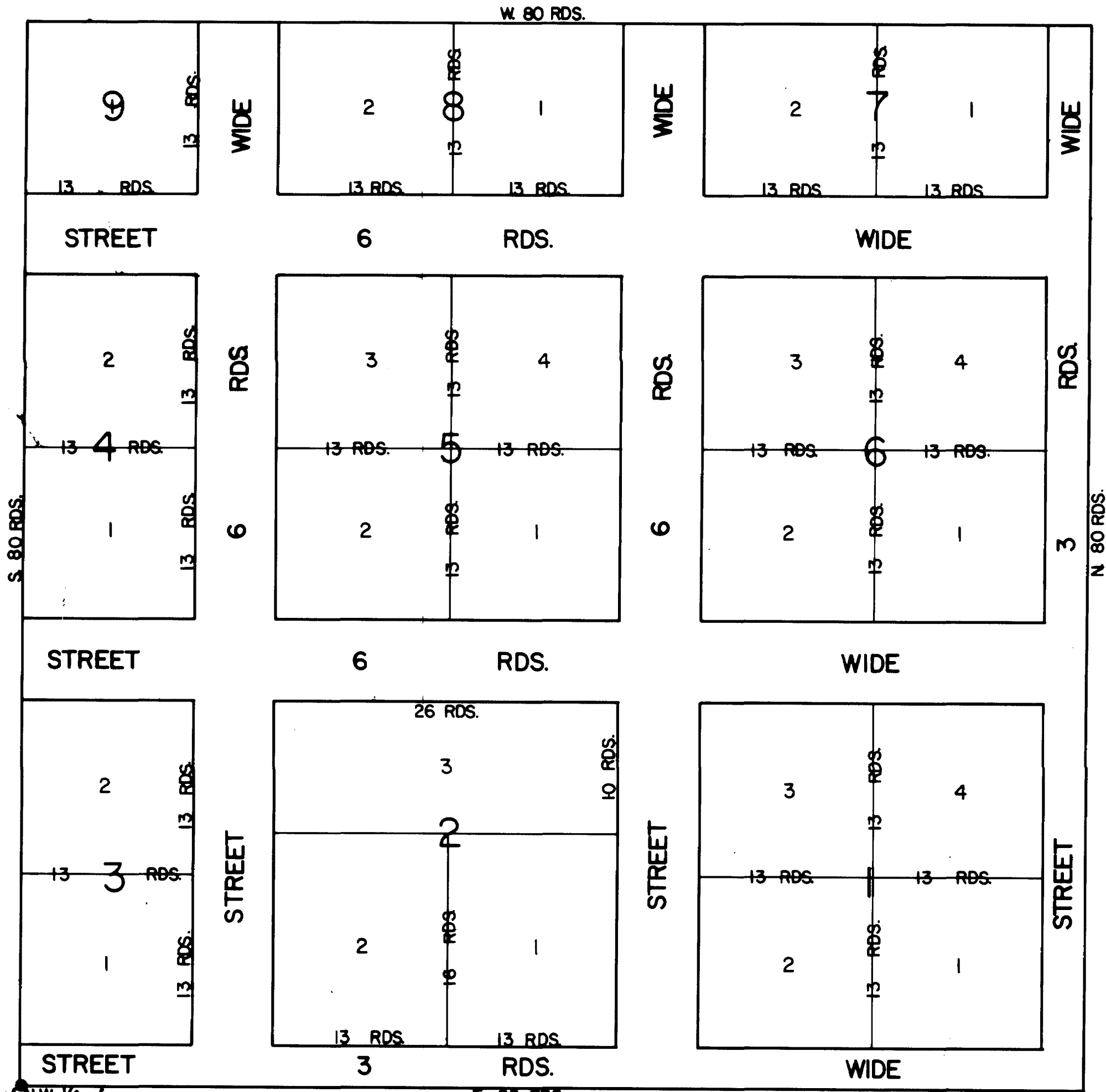

VAR. 16° 30' E
SCALE 2 CH. TO 1 INCH

SW. Cor. of N.W. 1/4 of
Sec 29 T. 18S. R. 8E.
S.L.M.

Know all men by these presents, that we Frank Carroll and Annie Carroll, husband and wife, of Orangeville, Emery Co., Utah, hereby certify and declare that we are sole owners of the lands embraced in this plat, that the lots herein shown are 13 by 13 rods, except lots 1 and 2 in block 2 which is 16 by 13 rods and lot 3 in block 2 which is 26 by 10 rods as shown in this plat, that all streets herein shown has a width as indicated in rods; that all streets herein shown are hereby set apart for and dedicated to the use of the public forever, that this plat is hereby denominated "Carroll's Subdivision Orangeville Townsite."

In witness whereof we have hereunto set our hands at Orangeville, this 16th day of April A.D. 1894.

Frank Carroll
Annie Carroll

Territory of Utah
County of Emery

On this 16th day of April, 1894, personally appeared before me Frank Carroll and Annie Carroll the signers of the above instrument who duly acknowledged to me that they executed the same.

George Fox
Justice of the peace

I, George Fox, a surveyor of Emery Co., Utah, hereby certify that the above plat embracing the following described land to wit:

Beginning at the S.W. cor. of the ^{See Note} SW 1/4 of sec. 29 Township 18S. Range 8E. S.L.M. thence East 80 rods, thence North 80 rods, thence West 80 rods, thence South 80 rods to place of beginning was by me surveyed and that the same is correct.

George Fox
Surveyor.

Approved April 27th A.D. 1894.

Herbert Savage
Probate Judge

Attest: Carl Wilberg

Clerk. Seal

Filed for record and recorded April 27th A.D. 1894, at

Carl Wilberg

Seal County Recorder of
Emery County, Utah.

Note: Original surveyor's certificate designates beginning point as the "S.W. cor. N.W. 1/4."

Notation made Oct. 11, 1928 by Vern Peterson,
Recorder, Emery Co., Utah.

Traced by svk
Johansen & Tuttle
8-75